

FURNITURE LEGEND

- FURNITURE DEALER TO VERIFY ALL FURNITURE SHOWN ON PLAN.
- ALL DIMENSIONS TO BE FIELD VERIFIED PRIOR TO INSTALLATION.

	EXISTING FURNITURE TO REMAIN		TASK CHAIR: EXISTING TO BE RELOCATED
	EXISTING FURNITURE TO BE RELOCATED		SIDE CHAIR: EXISTING TO BE RELOCATED
	EXISTING FURNITURE TO BE RELOCATED FROM 1500 MAIN STREET OFFICE		RECEPTION CHAIR: EXISTING TO BE RELOCATED
	WS42 - HERMAN MILLER "PROSPECTS": EXISTING TO BE RELOCATED		OCCASIONAL TABLE: EXISTING TO BE RELOCATED
	WS42 CALL CENTER - HERMAN MILLER "PROSPECTS": EXISTING TO BE RELOCATED		CONFERENCE ROOM TABLE: EXISTING TO BE RELOCATED
	WS84 - HERMAN MILLER: EXISTING TO BE RELOCATED		WORK TABLE: EXISTING TO BE RELOCATED
	BOOKCASES: EXISTING TO BE RELOCATED		IRON MOUNTAIN BIN: EXISTING TO BE RELOCATED
	LATERAL FILING CABINET: EXISTING TO BE RELOCATED		CONFERENCE ROOM CREDENZA: EXISTING TO BE RELOCATED
	TAB FILING SYSTEM: EXISTING TO BE RELOCATED		
	DOUBLE TAB FILING SYSTEM: EXISTING TO BE RELOCATED		

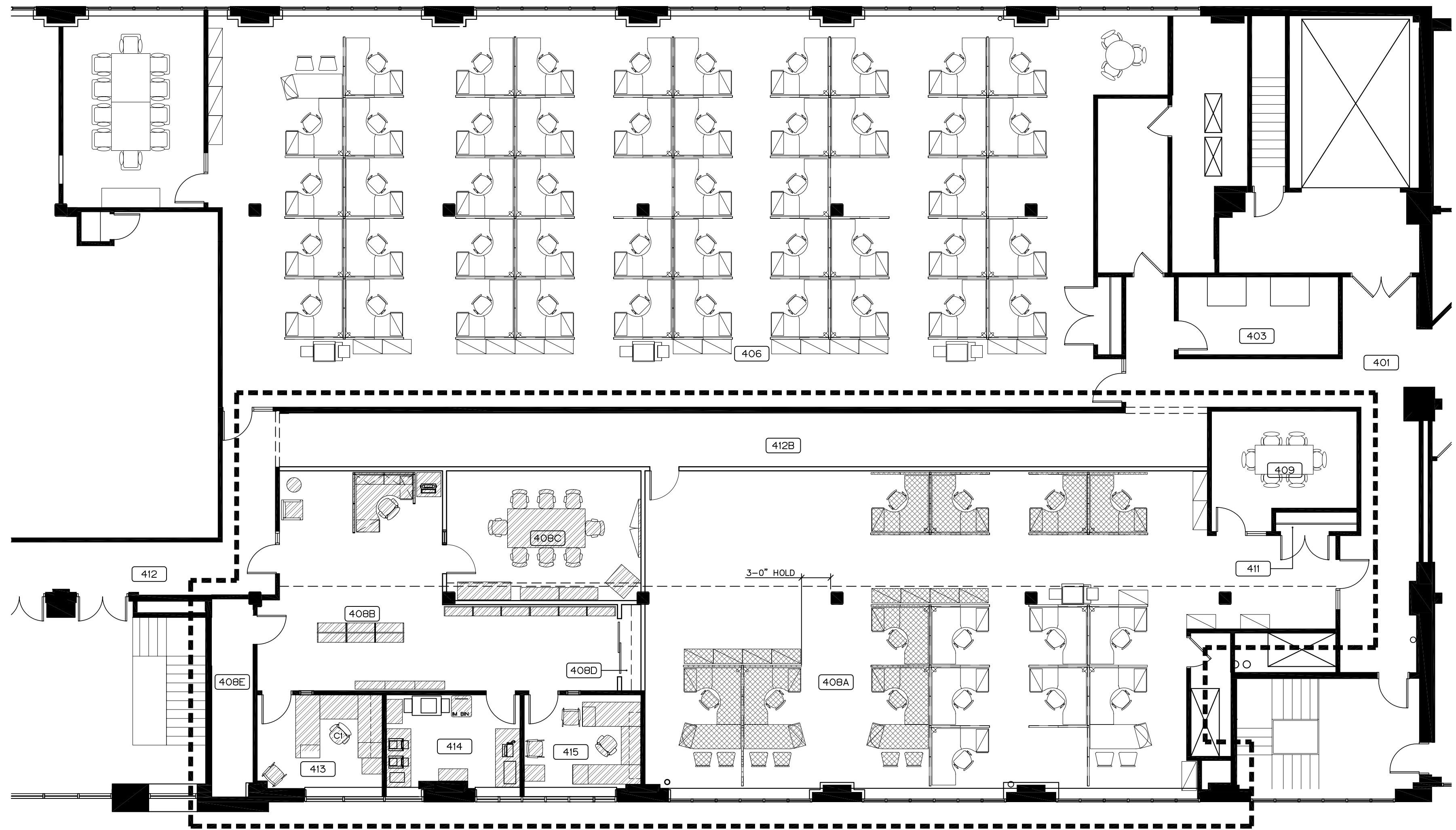

**HELLYER
BERMAN
LEWIS INC**
ARCHITECTURE
INTERIOR DESIGN

211 South 12th St.
Phila., PA 19107
215.922.7066

THE GENERAL CONTRACTOR IS RESPONSIBLE TO VERIFY ALL DIMENSIONS ON SITE AND CONFIRM SUCH DIMENSIONS AGAINST ACTUAL SITE CONDITIONS. THE GENERAL CONTRACTOR SHALL COORDINATE ALL WORK AND RELATED TRADES, AND SHALL NOTIFY THE ARCHITECT OF ANY INTERFERENCE OF MECHANICAL, ELECTRICAL, OR PLUMBING WORK WITH THE ARCHITECTURAL WORK AND OF ANY CONFLICTS OR DISCREPANCIES IN DIMENSIONS AGAINST ON SITE CONDITIONS PRIOR TO PROCEEDING WITH THE WORK OR PROCUREMENT OF MATERIALS.

Project:



1 Federal Street
Springfield, MA 01115

Project No: 044.82

Drawn by: BP
Checked by: KB
Approved by: HL

Client Approval: _____ Date: _____

Issue Date: 11/03/2011

No.	Date	Revision

Scale: 1/8" = 1'-0"

Drawing:
**Fourth Floor
Furniture
Plan**

No. **F-1.04**

FOR REFERENCE ONLY

