

**GENERAL NOTES**

- A. CODES:
  1. 780 CMR MASSACHUSETTS STATE BUILDING CODE, 7TH EDITION)
  2. AMERICAN INSTITUTE OF STEEL CONSTRUCTION (AISC)
- B. DESIGN LOADS:
 

EQUIPMENT & TANK LOADS (CAPACITY)	VARIABLES
-----------------------------------	-----------
- C. STRUCTURAL STEEL:
  1. ALL STRUCTURAL STEEL TO COMPLY WITH ASTM REQUIREMENTS AS FOLLOWS:
 

W SHAPES	A500	1/2" - 46 ksi
ASB OTHERS	A588	1/2" - 46 ksi
  2. BOLTED CONNECTIONS TO BE MADE WITH SLIP CRITICAL CONNECTION AS PER ASTM-325.
  3. MINIMUM THICKNESS OF CONNECTING ANGLES TO BE 3/8"
  4. ALL EXPLODED WELDING SHALL BE GROUND SMOOTH.
  5. ALL MISALIGNED BOLT HOLES IN STRUCTURAL STEEL SHALL BE PLUG WELDED SOLID AND REDRILLED FOR SPECIFIED BOLTS.
  6. C.G. SHALL VERIFY IN WRITING THAT ALL BOLTED CONNECTIONS ARE COMPLETED AS SPECIFIED AS PER ALL APPLICABLE AISC STANDARDS AND HAVE BEEN FIELD-TESTED ACCORDING TO AISC SPECIFICATIONS BEFORE LOADS ARE APPLIED.
  7. ALL UNBOLTED BOLT HOLES SHALL BE PLUG WELDED SOLID AND GROUND SMOOTH.
  8. ALL WELDING (IN SHOP & FIELD) SHALL COMPLY WITH LATEST AWS STANDARDS AND SHALL BE WELDED BY AN AWS-CERTIFIED WELDER.
  9. UNLESS OTHERWISE NOTED, ALL STRUCTURAL STEEL INCLUDING BOLTS, PLATES, ETC. SHALL BE HOT DIP GALVANIZED. ALL SHOP AND FIELD WELDS SHALL BE PAINTED WITH ONE COAT OF COLD-GALVANIZING PAINT.
- D. STEEL LINTELS:
  1. STEEL LINTELS AT ALL MASONRY OPENINGS, DOORS, WINDOWS, RECESSES, DUCTS, VENTS, ETC. (FINISHED UNDER MISCELLANEOUS MEAS) SHALL BE AS FOLLOWS:
 

OPENING WIDTH	LINTEL L&E WIDTH OF MASONRY
6'-1" - 8'-0"	1.5 x 3-1/2 x 8/16
8'-1" - 10'-0"	1.5 x 3-1/2 x 8/16
10'-1" - 12'-0"	1.5 x 3-1/2 x 8/16
12'-1" - 14'-0"	1.5 x 3-1/2 x 8/16
14'-1" - 16'-0"	1.5 x 3-1/2 x 8/16
16'-1" - 18'-0"	1.5 x 3-1/2 x 8/16
  2. BEARING OF LINTELS ON WALL TO BE 8" MINIMUM GROUT 3 CELLS (MIN.) SOLID
  3. BELOW FOR BEARING
  4. FOR 8" MASONRY SIZE WITH X3 FOR 3'-6" MAXIMUM OPENING.
  5. ALL EXTERIOR ANGLE LINTELS AND ALL BEAMS WITH P LINTELS TO BE HOT DIP GALVANIZED.
- E. MISCELLANEOUS:
  1. GROUT SHALL BE FIVE STAR EPOXY GROUT BY US GROUT CORP. OR EQUAL.
  2. VERIFY ALL EXISTING DIMENSIONS AND ELEVATIONS IN FIELD.
  3. SEE ARCHITECTURAL DRAWINGS FOR SIZE AND LOCATION OF NEW OPENINGS
  4. THROUGH EXISTING NON-BEARING WALLS FOR EXACT SIZE AND LOCATION OF ALL LAB SEE ARCHITECTURAL DRAWINGS FOR EXACT SIZE AND LOCATION OF ALL LAB
  5. NO MATERIAL SHALL BE FABRICATED UNTIL SHOP DRAWINGS ARE APPROVED. SHOP DRAWINGS SHALL BE SAME SIZE AND CLARITY AS CONTRACT DRAWINGS. AND SHALL BE COORDINATED WITH OTHER RELATED SHOP DRAWINGS. NO PERMISSION WILL BE GRANTED FOR ANY STRUCTURAL DRAWINGS TO BE REPRODUCED FOR USE AS SHOP DRAWINGS.
  6. A MINIMUM OF FOUR HARD COPIES SHALL BE PROVIDED WITH EACH SHOP DRAWING SUBMITTAL (ALL MATERIALS).
  7. G.C. SHALL COORDINATE STEEL LOCATIONS WITH EXISTING PIPES, CONDUITS, ETC. LOCATED BELOW THE EXISTING FLOOR SLAB. G.C. SHALL NOTIFY THE OWNER OF ANY CONFLICTS BEFORE RECORDING IF ANY EXISTING CONDITIONS DIFFER FROM THOSE NOTED IN THE CONTRACT DOCUMENTS.
  8. C.G. SHALL COORDINATE THE WORK OF ALL TRADES TO PROVIDE FUNCTIONAL AND DIMENSIONAL COMPATIBILITY BETWEEN ALL COMPONENTS.
  9. THE G.C.'S BID SHALL INCLUDE THE COST ASSOCIATED WITH ALTERNATE SECTION 1. A CREDIT SHALL BE PROVIDED TO THE OWNER FOR EACH LOCATION WHERE SECTION 1 OR 0.1 IS ABLE TO BE USED INSTEAD OF ALTERNATE SECTION 1.

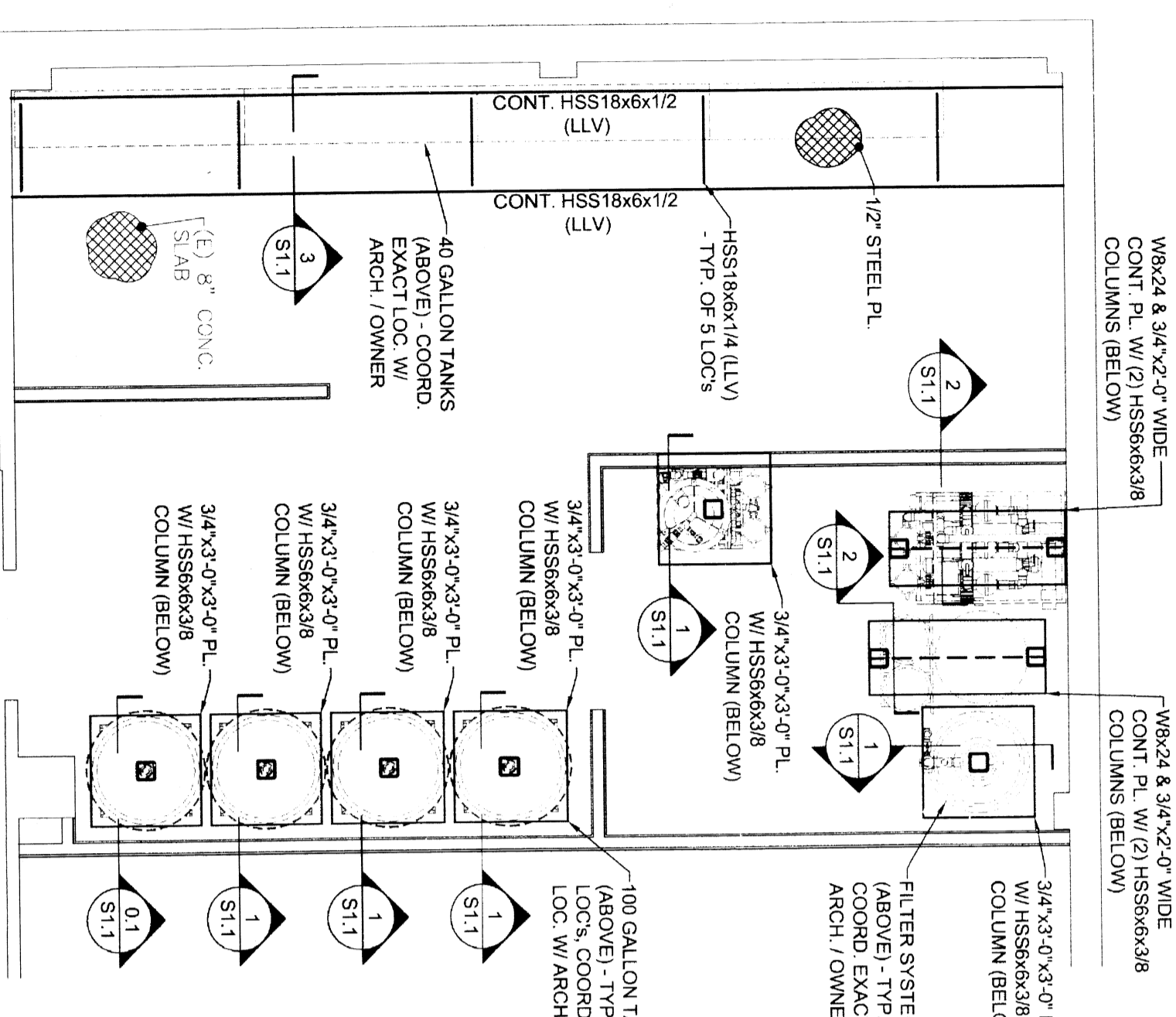

**NOTES:**

- 1) INDICATES EXISTING, OTHERWISE NEW.
- 2) FIELD VERIFY EXISTING CONDITIONS AND DIMENSIONS PRIOR TO FABRICATION.
- 3) LOCATION OF STEEL SUPPORTS TO BE CENTERED UNDER EQUIPMENT.
- 4) EQUIPMENT (STEEL) SUPPORTS TO BE CENTERED UNDER EQUIPMENT.
- 5) COORDINATE EXACT LOCATION OF EQUIPMENT WITH ARCHITECT/OWNER PRIOR TO CONSTRUCTION.

**FISH LAB FLOOR REINFORCING**  
SCALE: 1/4" = 1'-0"

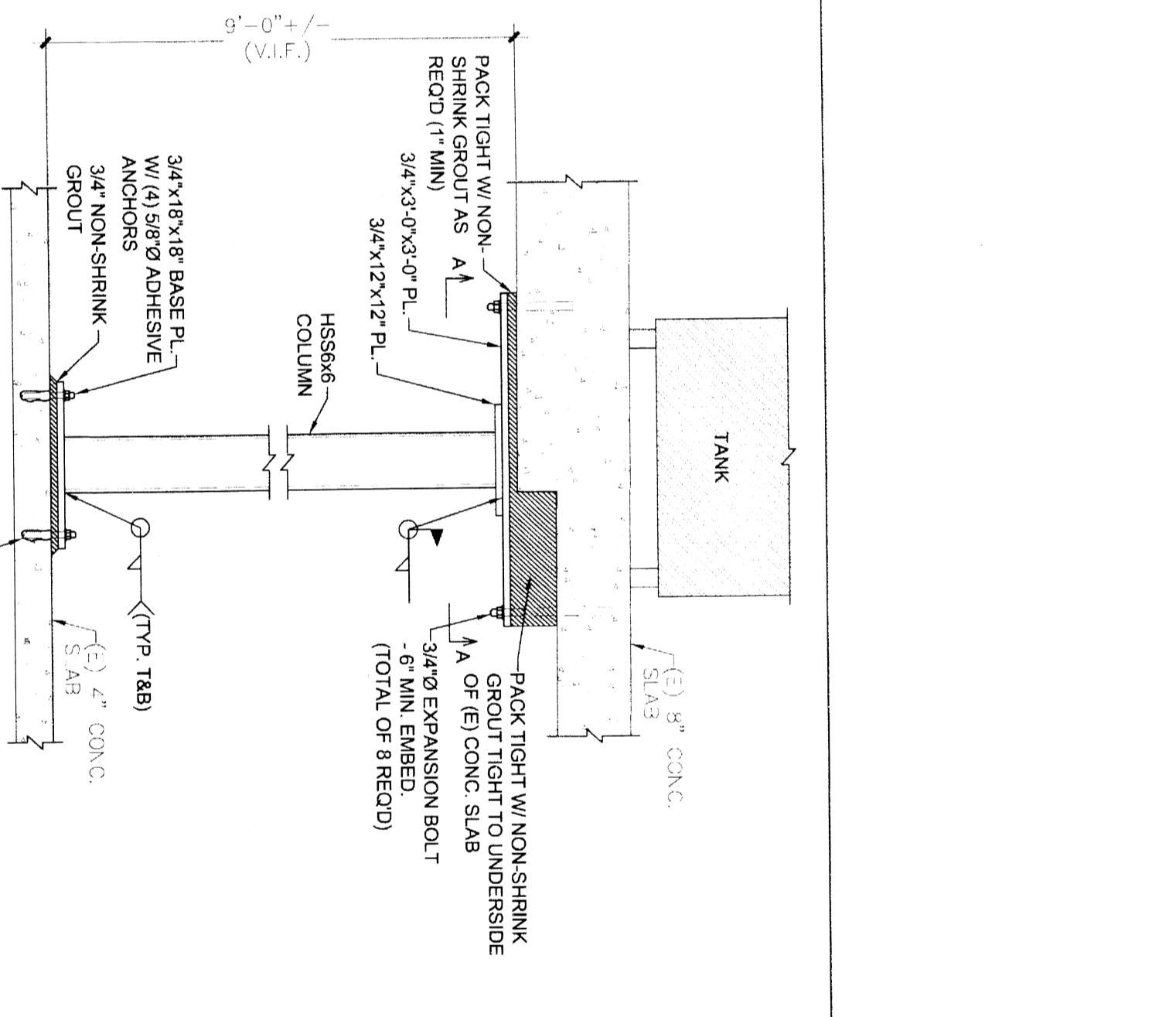

**NOTES:**

- 1) EXISTING PIPING, CONDUITS, ETC. BELOW
- 2) IF THE HSS8x6 COLUMN IS TO BE CENTERED UNDER EQUIPMENT, SEE ALTERNATE SECTION 1. SIMILAR SEE NOTE #8 IN SECTION 'D' - 'MISCELLANEOUS' OF THE GENERAL NOTES)

**SECTION 0.1**  
SCALE: 3/4" = 1'-0"

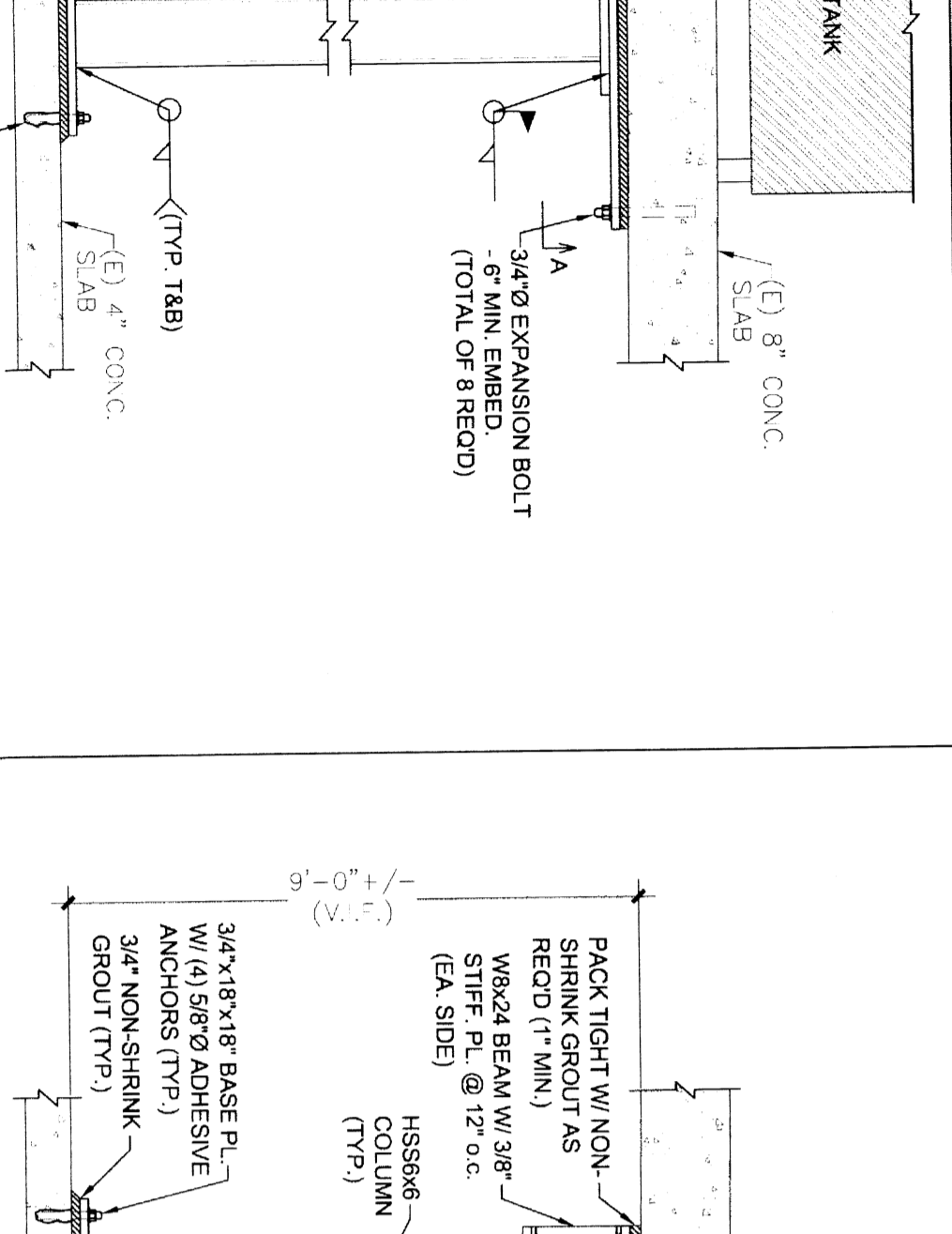

**NOTES:**

- 1) EXISTING PIPING, CONDUITS, ETC. BELOW
- 2) THE 3/4" PLATE DUE TO FIELD OBSERVATIONS, SEE ALTERNATE SECTION 1 (SEE NOTE #8 IN SECTION 'D' - 'MISCELLANEOUS' OF THE GENERAL NOTES)

**SECTION 1**  
SCALE: 3/4" = 1'-0"

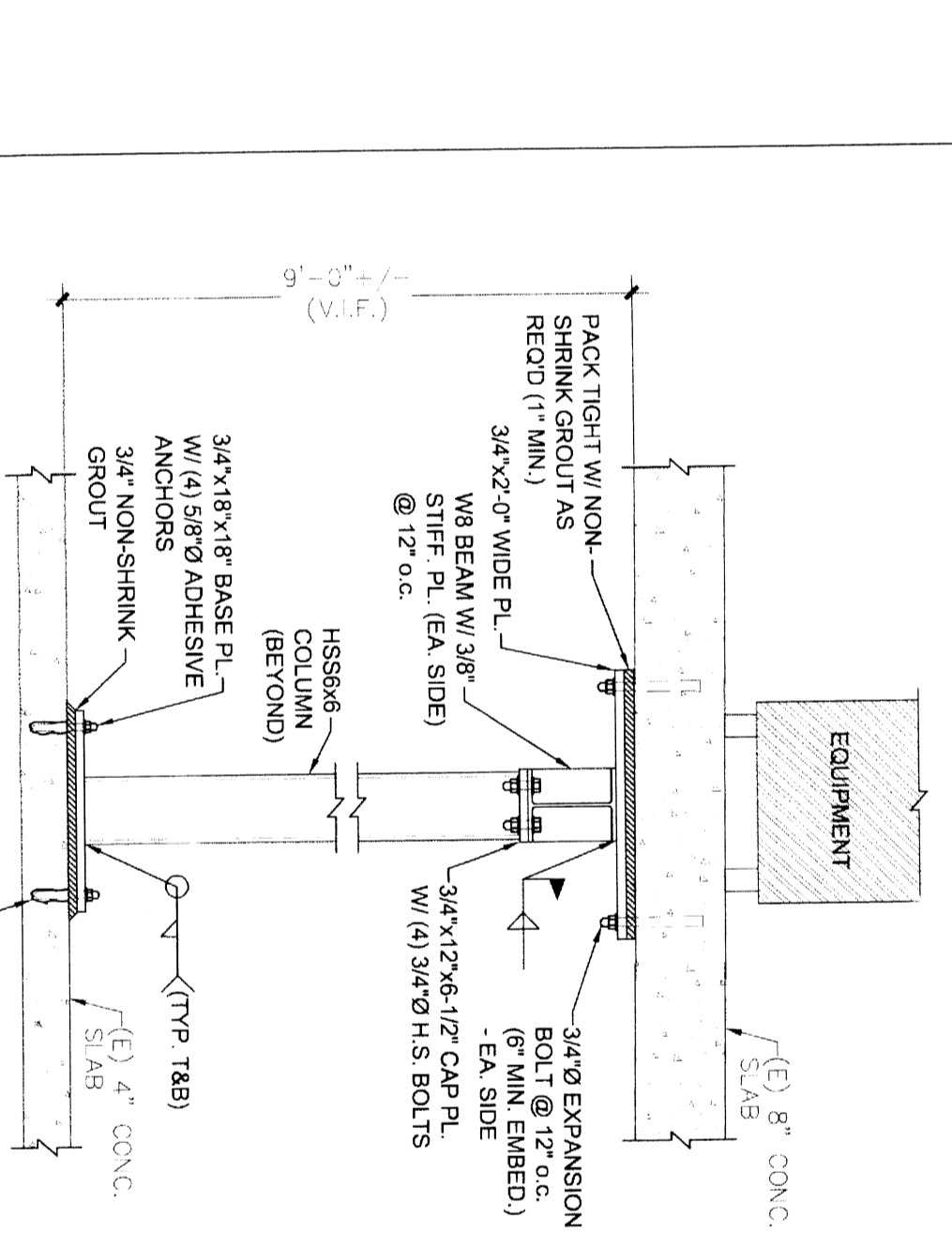

**NOTE:**

- 1) EXISTING PIPING, CONDUITS, ETC. BELOW
- 2) 8" CONC. SLAB NOT SHOWN FOR CLARITY

**SECTION 2**  
SCALE: 3/4" = 1'-0"

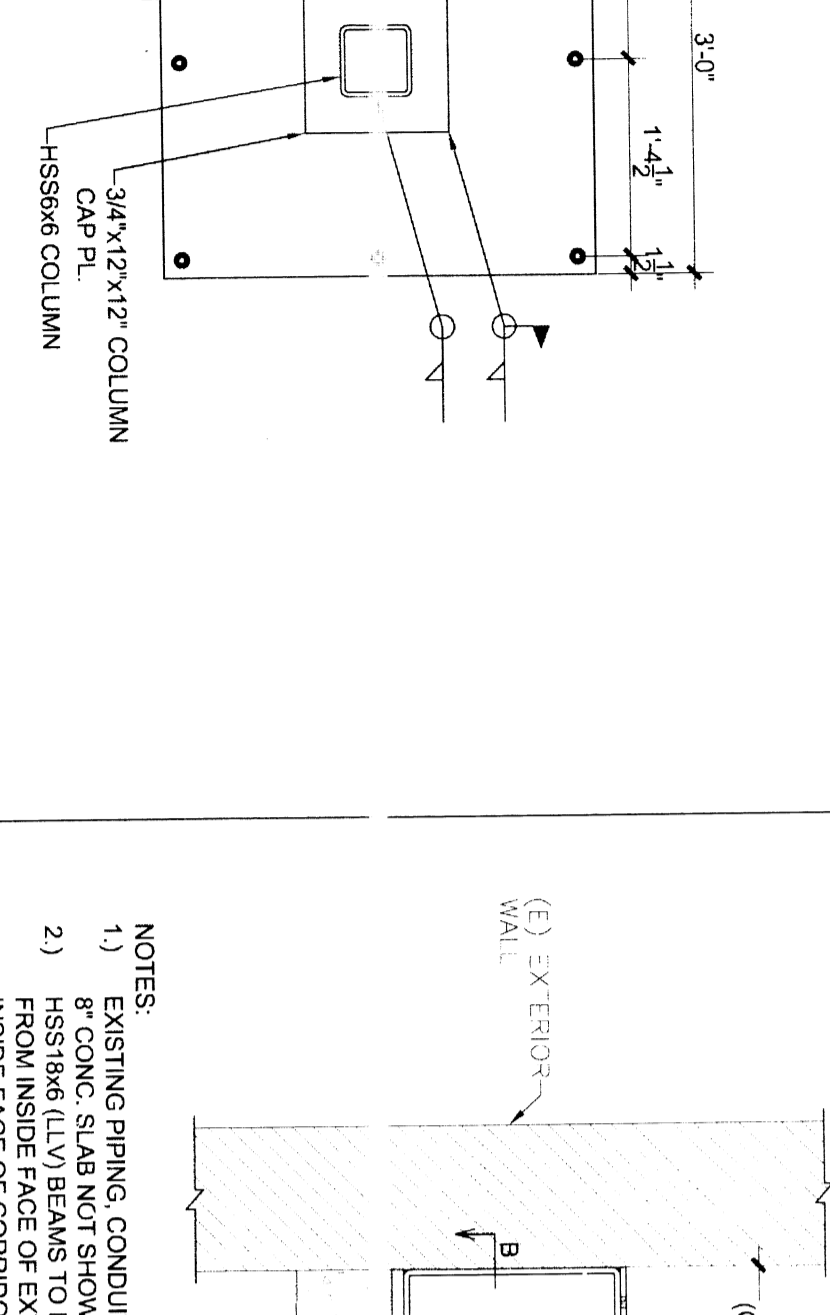

**NOTES:**

- 1) EXISTING PIPING, CONDUITS, ETC. BELOW
- 2) HSS8x6 COLUMN BEAMS TO BE CONTINUOUS FROM INSIDE FACE OF EXTERIOR WALL TO INSIDE FACE OF CORRIDOR WALL.

**SECTION A-A**  
SCALE: 3/4" = 1'-0"

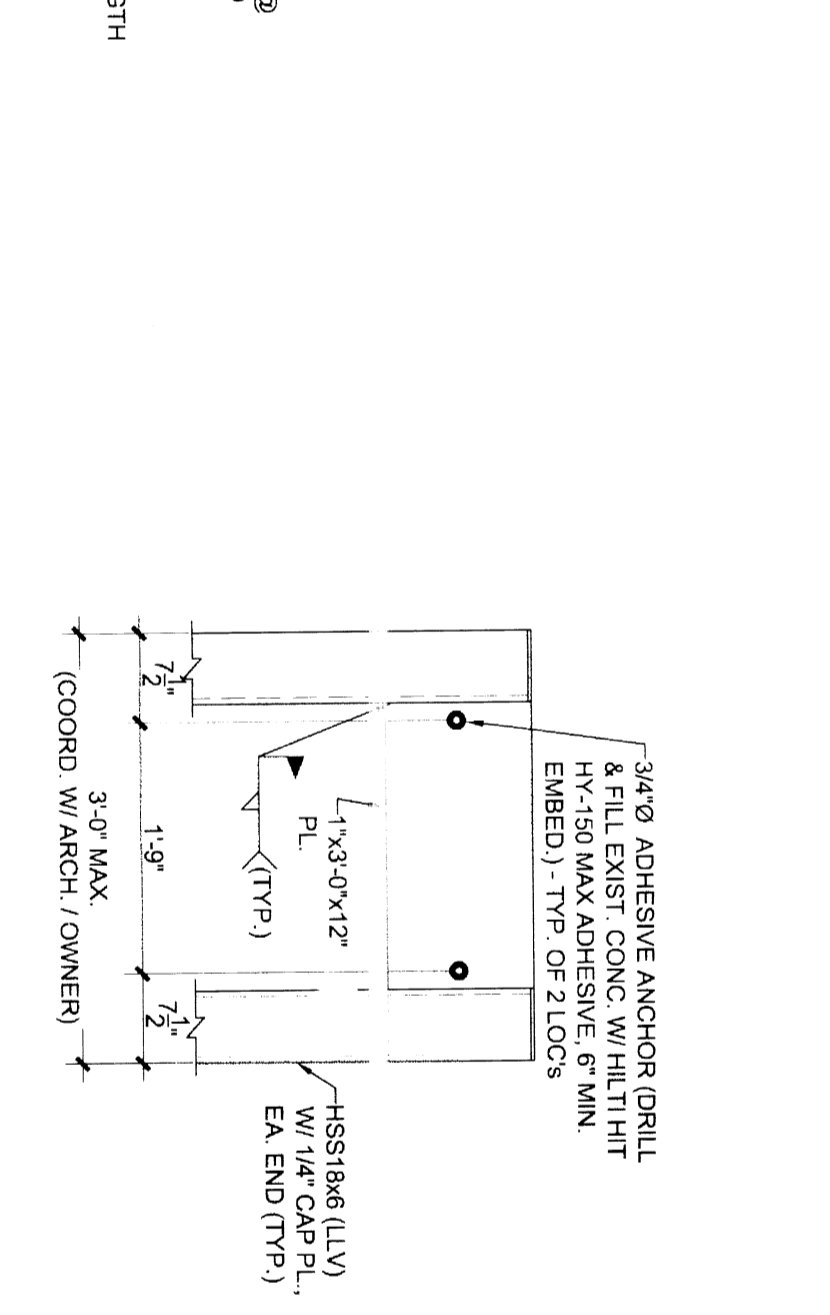

**NOTE:**

- 1) EXISTING PIPING, CONDUITS, ETC. BELOW
- 2) HSS8x6 COLUMN BEAMS TO BE CONTINUOUS FROM INSIDE FACE OF EXTERIOR WALL TO INSIDE FACE OF CORRIDOR WALL.

**SECTION B-B**  
SCALE: 3/4" = 1'-0"

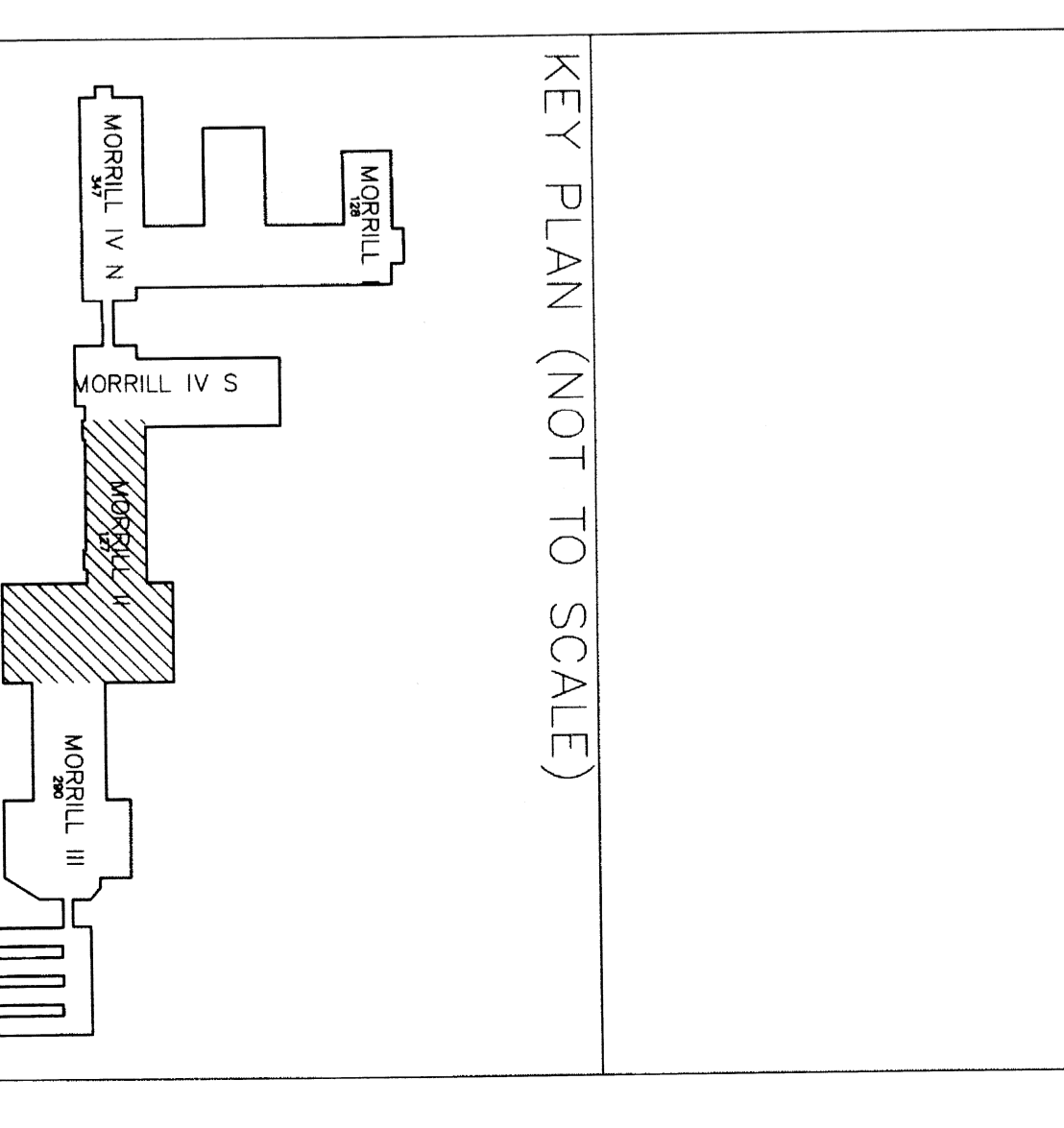

**BID SET**

BY	DATE	APP'D	DATE	WORK ORDER NO.	PROJ. CONTRACT NO.
TPA	1/19/10			001758	UNV-11-022
TRD					
CKD	1/19/10				
DSS					

**UNIVERSITY OF MASSACHUSETTS BUILDING RENOVATIONS**  
MORRILL II ROOMS 336/338 RENOVATIONS

**BUILDING PLANS**

**JSE**  
Johnson Structural Engineering, Inc.  
30 Faith Avenue, Auburn  
Massachusetts 01501  
phone: (609) 892-2535  
fax: (609) 892-3393

**REV. NO.** DESCRIPTION BY APP'D DATE

**UNIVERSITY OF MASSACHUSETTS BUILDING RENOVATIONS**  
MORRILL II ROOMS 336/338 RENOVATIONS